

PRESBYTERY extg.

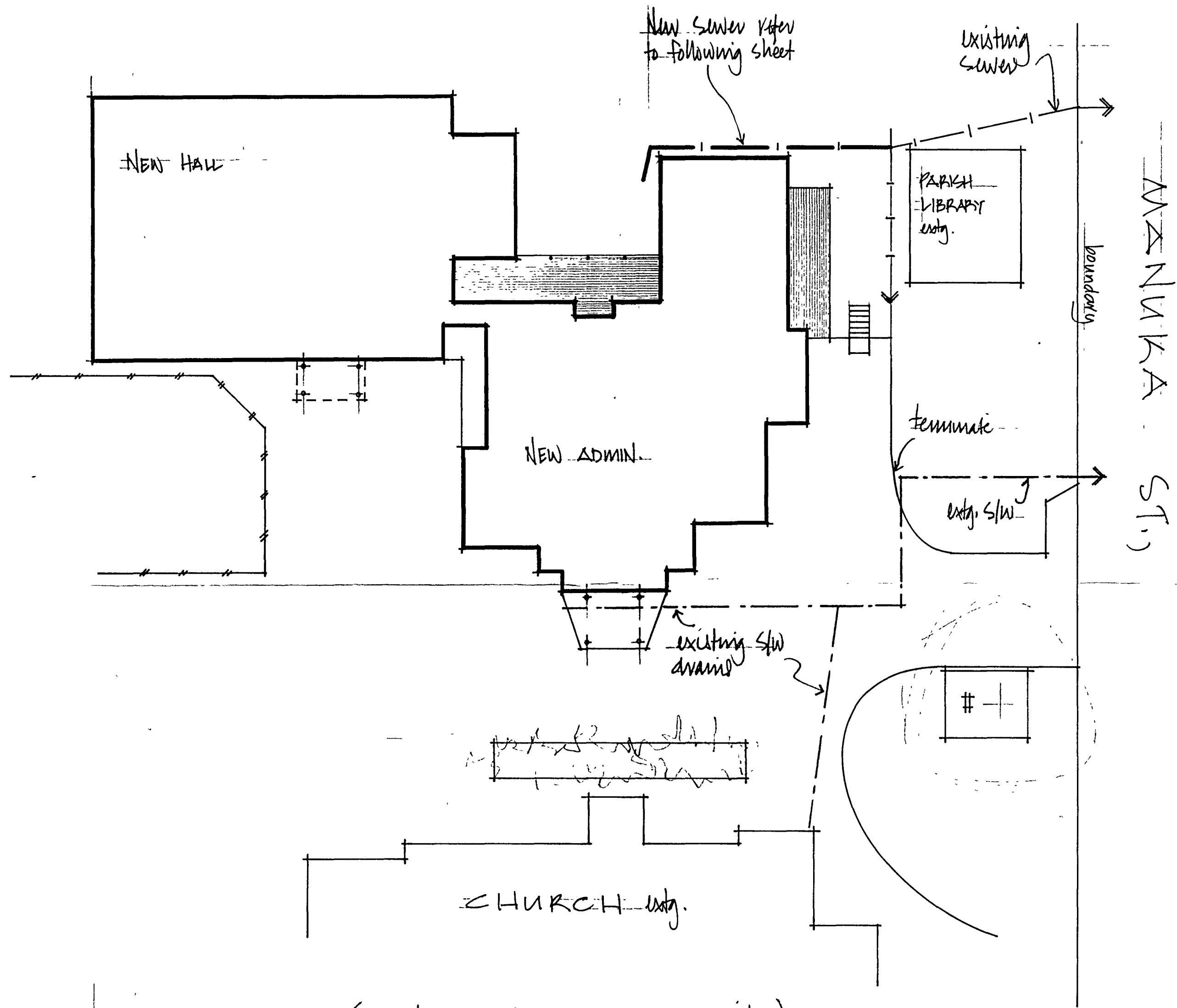

PART SITE PLAN (AND DRAINAGE LINK UP info.)
1:200

ST. JOSEPHS SCHOOL - NELSON
NEW ADMIN./HALL and PARISH CENTRE

CLAPCOTT CONSULTANCY LTD	
P O Box 13-040, Hastings	
Telephone: (06) 870 7560	
Facsimile: (06) 870 7561	
Architects	
Project Managers	
Property Consultants	

06/39

10